

River concept project

Creating connections, green spaces and points of interest

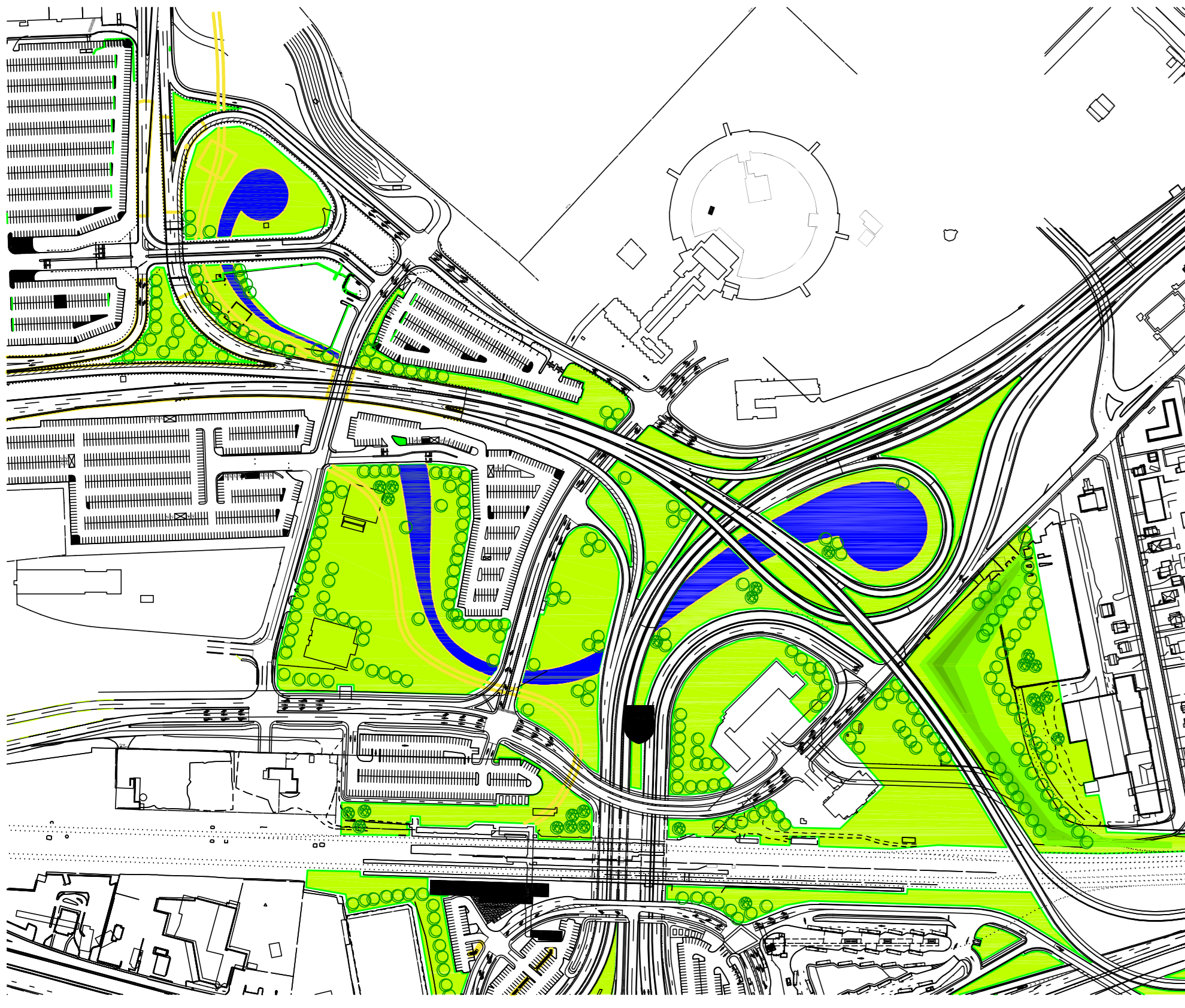

SPRING AREA
DESCRIPTION:
Final part of river concept - Spring. Water feature offering welcome and farewell special attention to the users of Trudeau Airport.
OBJECTIVES:

- Creating emblematic composition at Dorval Interchange
- Connecting Dorval Station with Trudeau Airport

SOLUTIONS:

- Creating water/ice feature with illuminated water sprays for warm season and ice producing small jets for the winter.
- From the bigger lake water goes to the walkway that connects Dorval Station with Trudeau Airport, creating artificial river going to the airport.



SAINT-PIERRE INTERCHANGE
DESCRIPTION:
Saint-Pierre interchange
OBJECTIVES:

- Connecting Saint-Pierre Neighborhood with Lachine and Lachine Canal areas
- Increasing safety of the area

SOLUTIONS:

- Creating park area west of the railway. This area connects Meadowbrooks golf area with Lachine Canal by the Saint-Pierre interchange
- Creating sound barriers at the north of interchange.

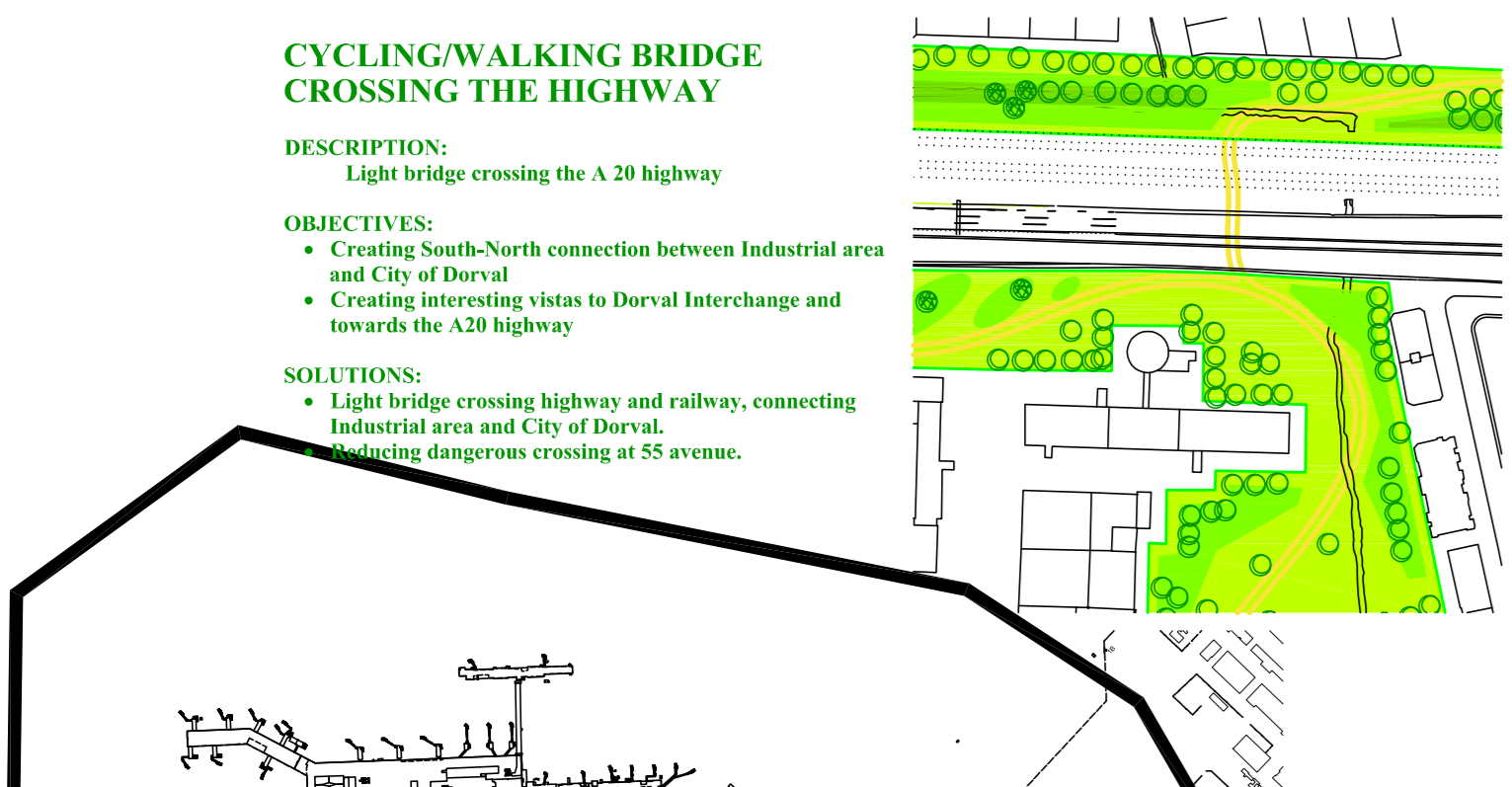

LACHINE PARK NORTH OF THE HIGHWAY A20
DESCRIPTION:
Park area
OBJECTIVES:

- Creating area connecting residual vegetation and giving the opportunity to walk/cycle around the A20
- Creating area separating industrial and living area
- Creating connections between Meadowbrooks golf area and living area south of A20

SOLUTIONS:

- Creating park area with attention on vistas from A20, railroad and walkway through the park.
- Separating of park and industrial area with possibility of usage by working persons.



TURCOT INTERCHANGE
DESCRIPTION:
Complex structure with a lot of small green spaces
OBJECTIVES:

- Creating complete green structure with visual connection between small green islands
- Creating connection between City of Westmount, Saint-Henri Neighborhood, Upper Lachine and Saint-Jacques Escarpment

SOLUTIONS:

- Elevated area at the south of the structure and using north elevation to create complete green structure
- By using part of cycling network creating a connection between surrounding areas
- Creating interesting vistas to Boat park and Glen Campus

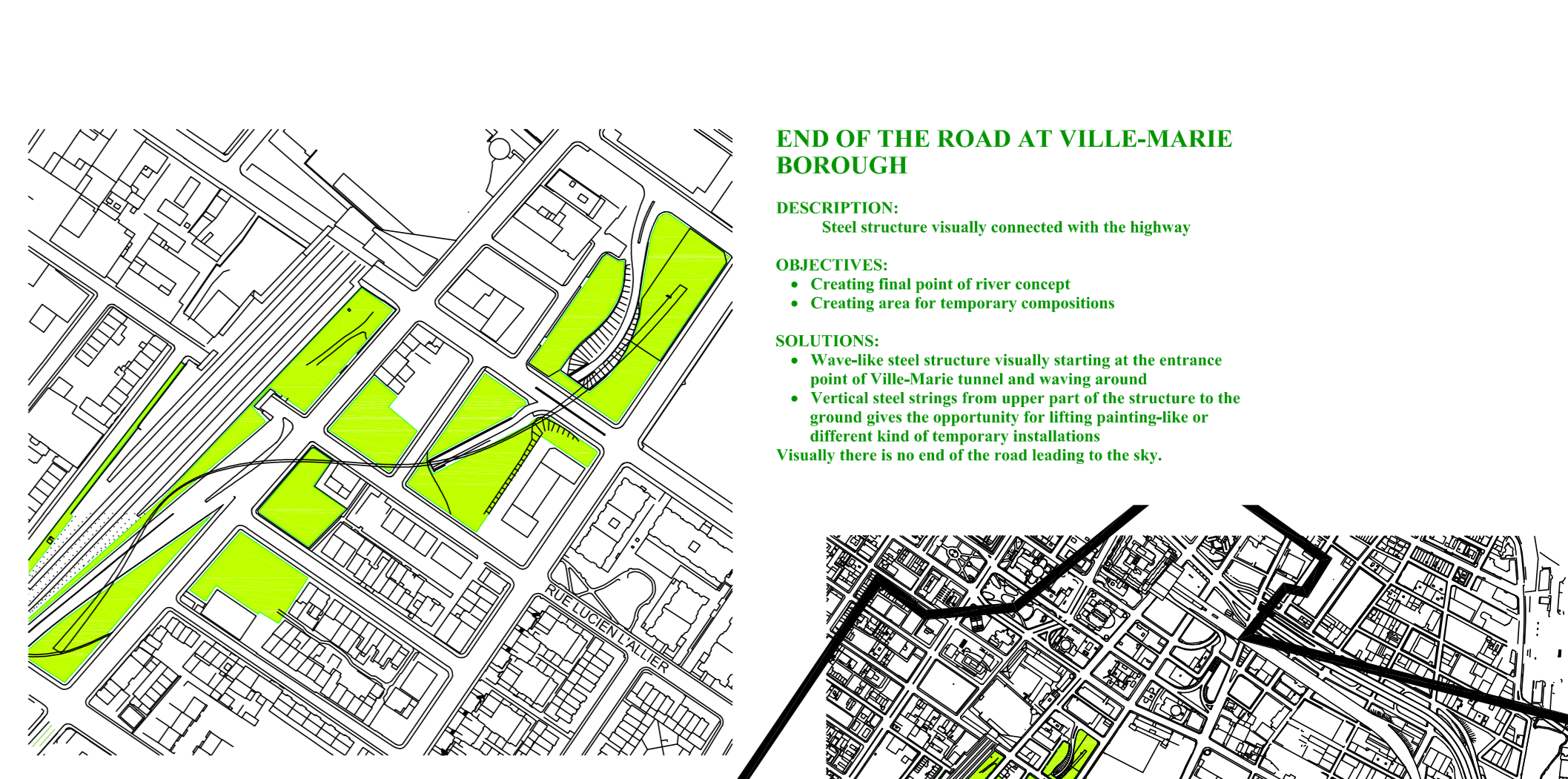

END OF THE ROAD AT VILLE-MARIE BOROUGH
DESCRIPTION:
Steel structure visually connected with the highway
OBJECTIVES:

- Creating final point of river concept
- Creating area for temporary composition

SOLUTIONS:

- Wave-like steel structure visually starting at the entrance point of Ville-Marie tunnel and waving around
- Vertical steel strings from upper part of the structure to the ground gives the opportunity for lifting painting-like or different kind of temporary installations
- Visually there is an end of the road leading to the sky.

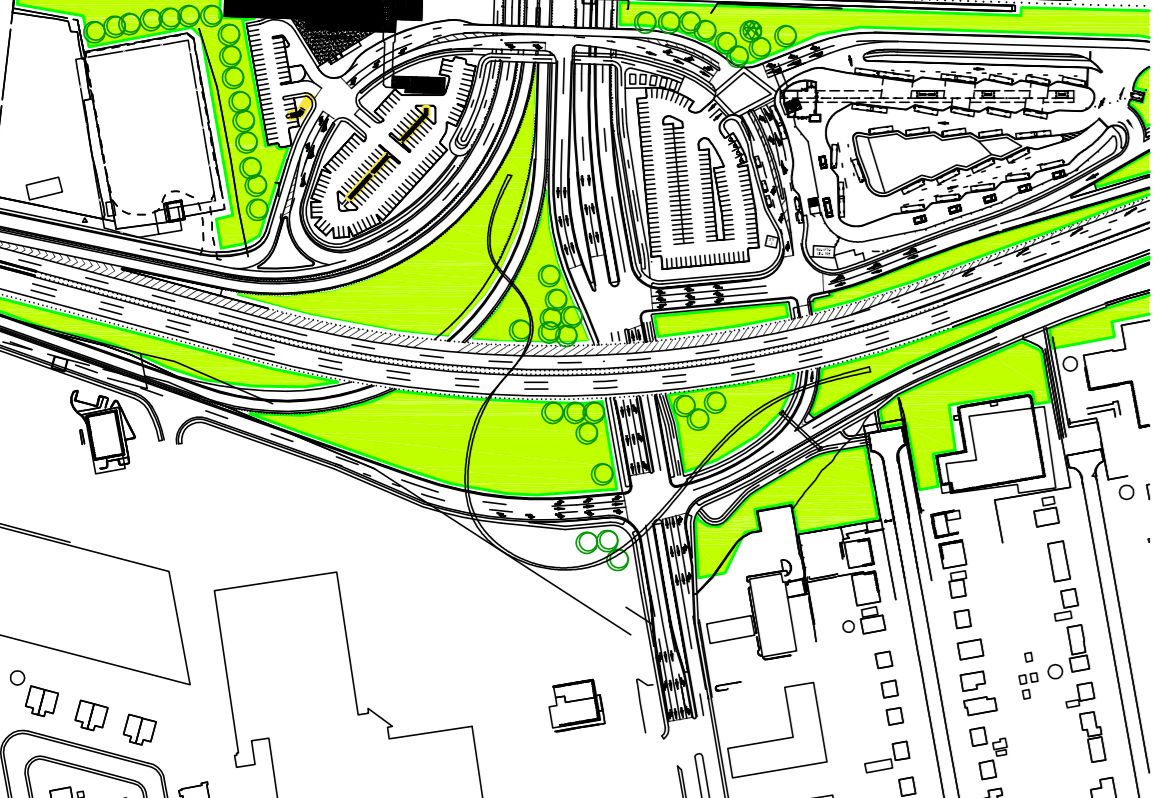

WAVE STRUCTURE AT DORVAL INTERCHANGE
DESCRIPTION:
Wave-like steel structure
OBJECTIVES:

- Creating interesting vistas from and to Dorval Interchange
- Creating area for temporary composition

SOLUTIONS:

- Wave-like steel structure which leads the view to curve to Center of Montreal
- Vertical steel strings from upper part of the structure to the ground gives the opportunity for lifting painting-like or different kind of temporary installations



CYCLING/WALKING BRIDGE CROSSING THE HIGHWAY
DESCRIPTION:
Light bridge crossing the A 20 highway
OBJECTIVES:

- Creating South-North connection between Industrial north and living South part of Lachine Borough
- Creating connection between Lachine Station and living part of Lachine Borough without using 55 avenue crossing

SOLUTIONS:

- Light bridge crossing highway and railway, connecting industrial area and City of Dorval.



MEADOWBROOKS GOLF AREA
DESCRIPTION:
Golf course area
OBJECTIVES:

- Treating Meadowbrooks golf area like a part of park area by the corridor

SOLUTIONS:

- Creating walkway without crossing playground areas
- By the future redevelopment of this area this walkway will connect Lachine and Cabot-Saint-Jacques area with Lachine park north of A20.



SAINT-PIERRE LAKE AND MOUNTAIN AREA
DESCRIPTION:
Park area by the interchange
OBJECTIVES:

- Creating emblematic vistas from the interchange

SOLUTIONS:

- Creating park and lake area out of interchange creating interesting vistas to the park and near Lachine Canal



CABOT AREA PARK
DESCRIPTION:
Industrial area park connecting Saint-Henri Neighborhood and Aqueduct Canal
OBJECTIVES:

- Connecting Saint-Henri Neighborhood and Aqueduct Canal
- Easy passage to Aqueduct Canal

SOLUTIONS:

- Park area and light bridge to Aqueduct Canal
- Walkways to Lachine area

SAINT-HENRI NEIGHBOURHOOD GREEN AREAS
DESCRIPTION:
Green areas across the railway
OBJECTIVES:

- Reducing noise from the railway
- Connecting north and south part of Saint-Henri Neighborhood

SOLUTIONS:

- Creating elevated areas by the railway that forms tunnel-like structure. This structure significantly reduce noise and give possibility of walkways crossing

FUTURE AQUAPARK AREA
DESCRIPTION:
Area north of the Boat park crossing the Lachine Canal
OBJECTIVES:

- Increasing interest at Boat park area
- Creating a link to Anguineau Park

SOLUTIONS:

- Green area between Saint-Denis Borough and industrial area, that leads to Anguineau Park
- Future possibility for aquapark



BOAT PARK
DESCRIPTION:
As a part of river concept giant boat that leads towards the center
OBJECTIVES:

- Creating park area with reduction of noise from A20, railway and autoroute
- Creating point of interest connecting Upper Lachine and Saint-Denis Borough
- Link between Saint-Jacques Escarpment and Lachine Canal
- Using of area as development and green space

SOLUTIONS:

- Creating Boat park with shape preserving from the noise of surrounding areas
- Creating of opportunity for up to 30 storey building areas at both ends of the park
- Creating emblematic views from and to different areas like Saint-Jacques Escarpment, Lachine Canal, Mount Royal etc.
- Creating local public Entertainment with great possibilities for children and groups
- Creating connection between Saint-Jacques Escarpment and Lachine Canal
- Creating spectacular views from any kind of transport - boat, car, train, bicycle, plane etc.
- Creating emblematic night vistas by illuminating 30-shapred structure with rows of light representing ropes of a boat
- Potential of closing with glass part of upper area and creating glass "wave" art structure with exotic plants and animals