

DEFINING TRANSIT STOPPING CREATING ACTION SPACES AND DYNAMIC PHASES

(passing - stopping - connecting - transferring) and stages (anthromechanical - anthropometric) offering multi directional possibilities of movement and actions (transitory stopping - transitory passing).

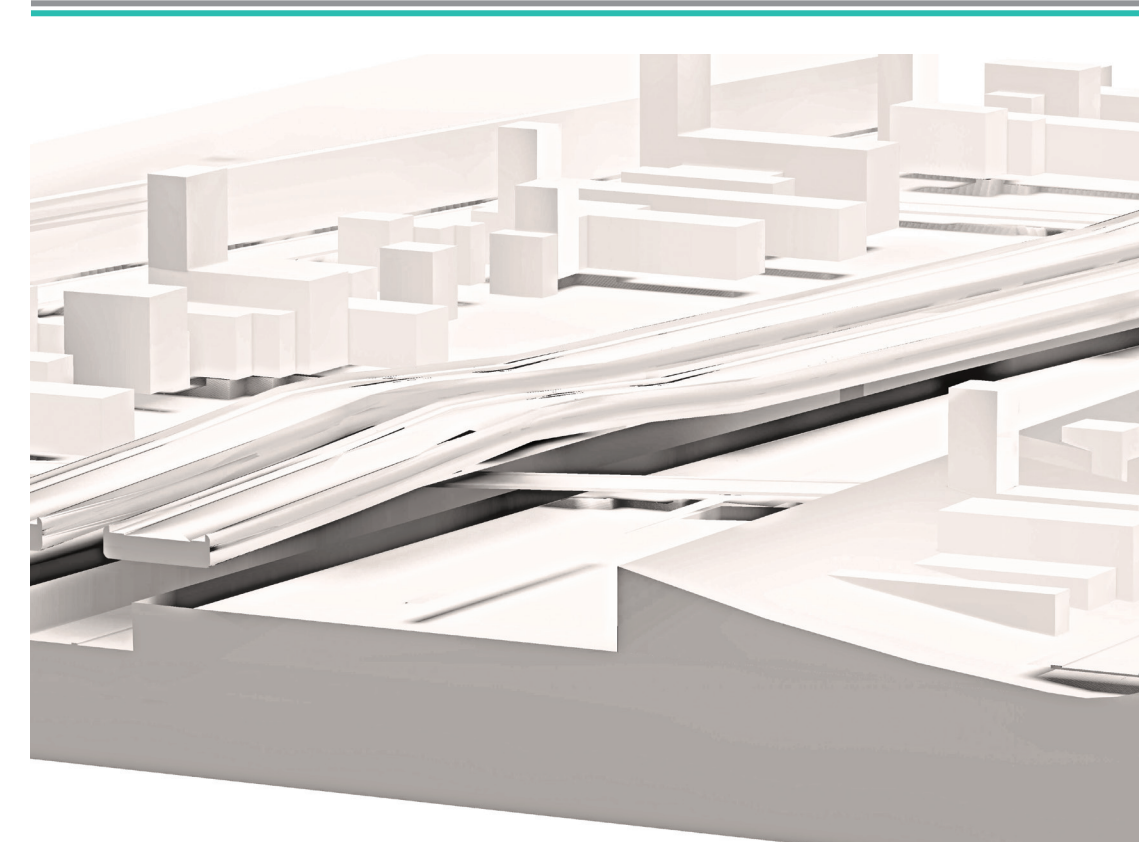

ACTION, INTERACTION, MOTION

The immediate space is transformed through action and interaction and choreographed through motion of different direction and intensity.

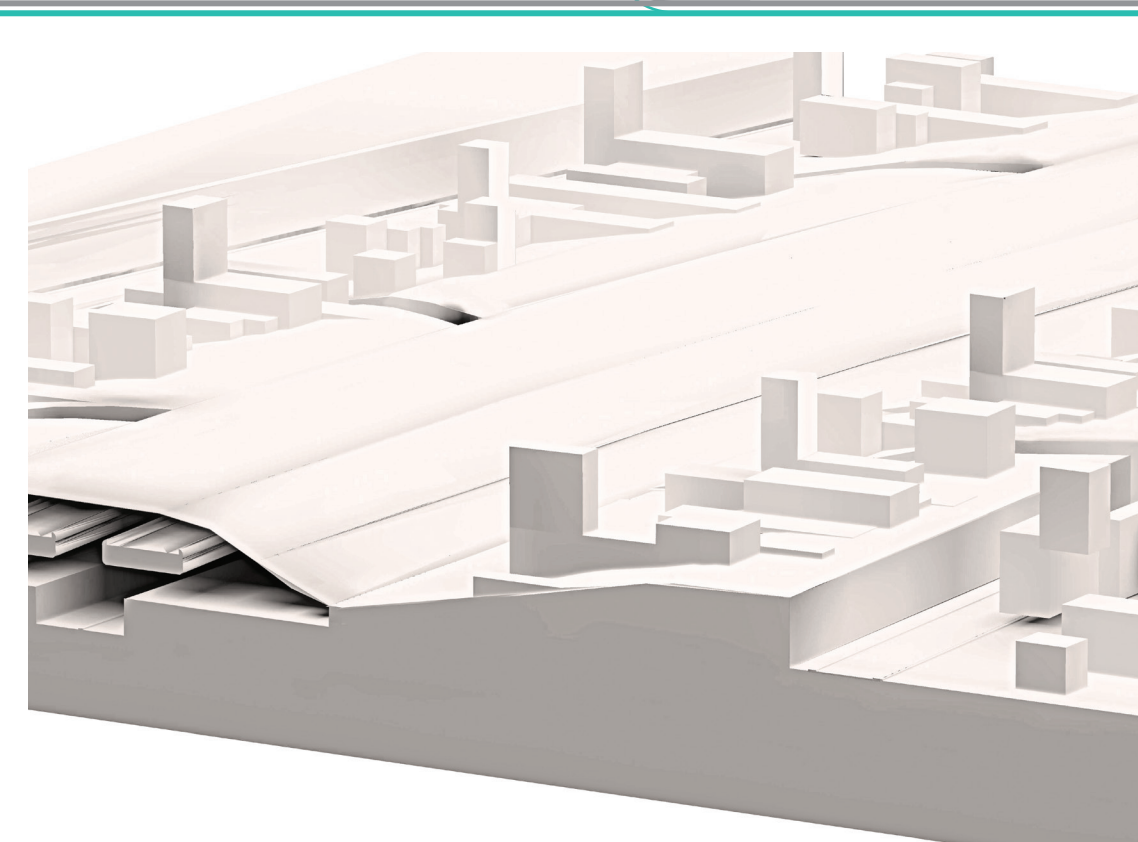

PUBLIC DESTINATION

West Side Central Park restructuring the west side of Montrealopolis around a public communal destination.

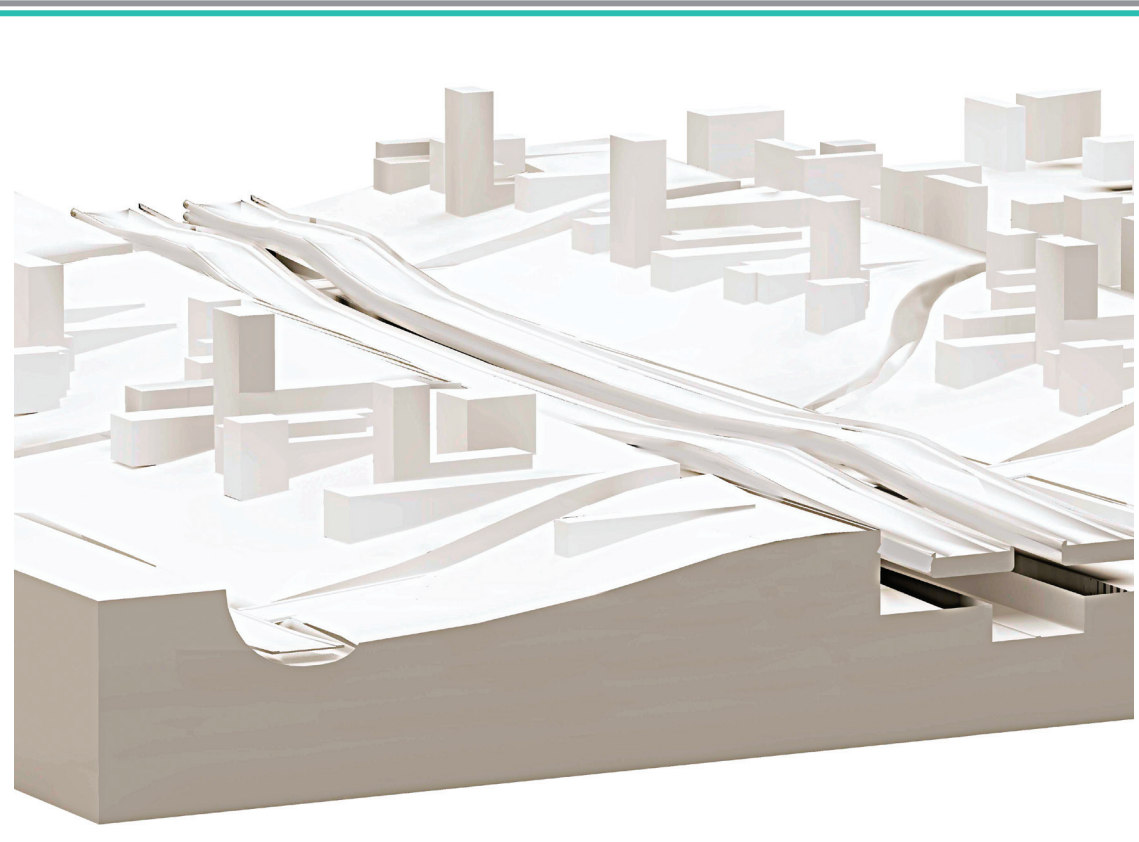

FINAL DESTINATION

The goal is to transform a monofunctional and monodirectional space that synchronizes transit motion into multifunctional transit stations or final destination.