

THE DORVAL INTERCHANGE

Including a new landmark will revitalise the northern area of Dorval creating more movement between the other points of interest like the train station, bus terminal, commercial area, hotels and of course the airport. The tower will include, at the base an explanatory and descriptive area of the Dorval development and along its height a demonstration of vertical farming. At the same time, the top of the tower offers an overview of the outgoing projects.

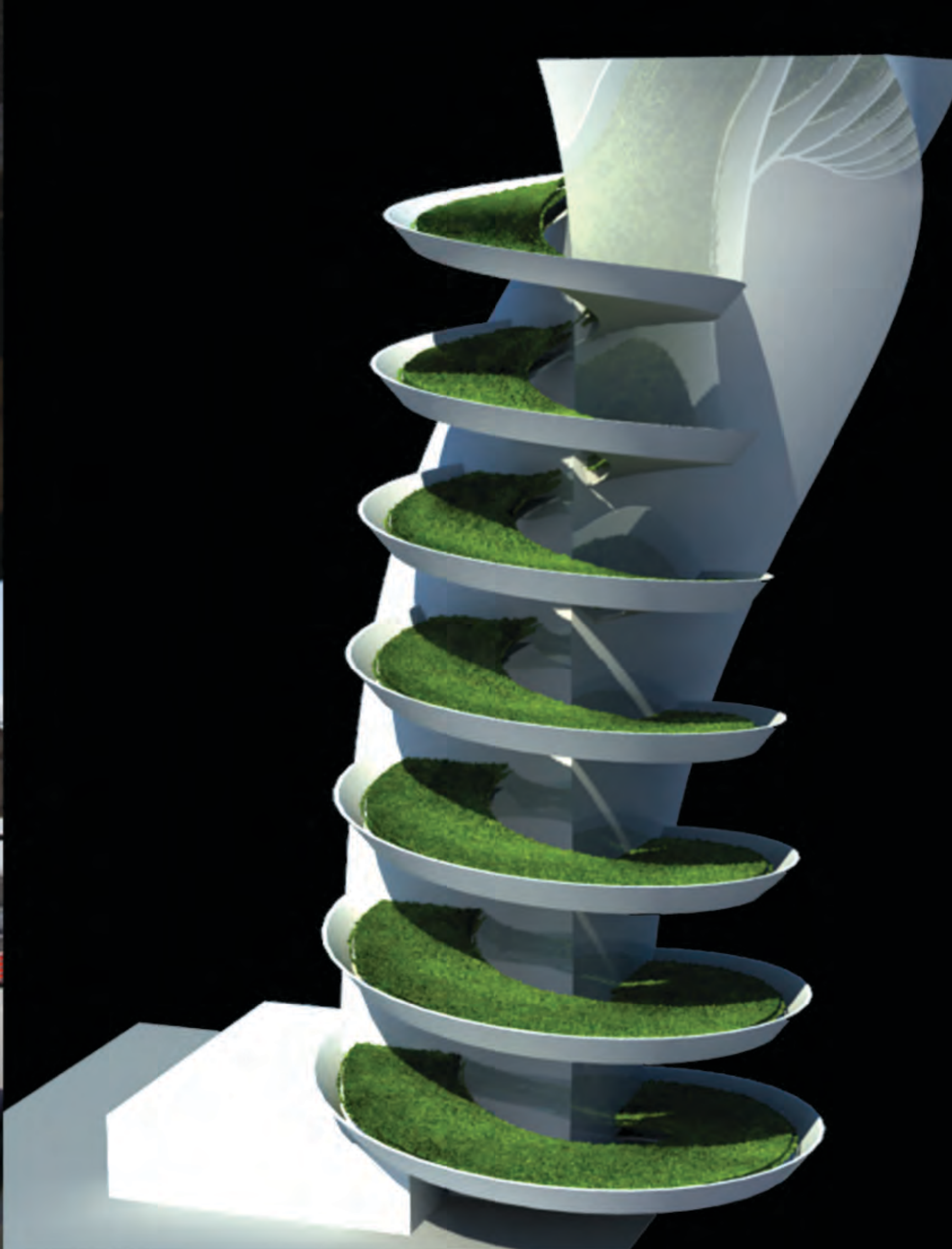
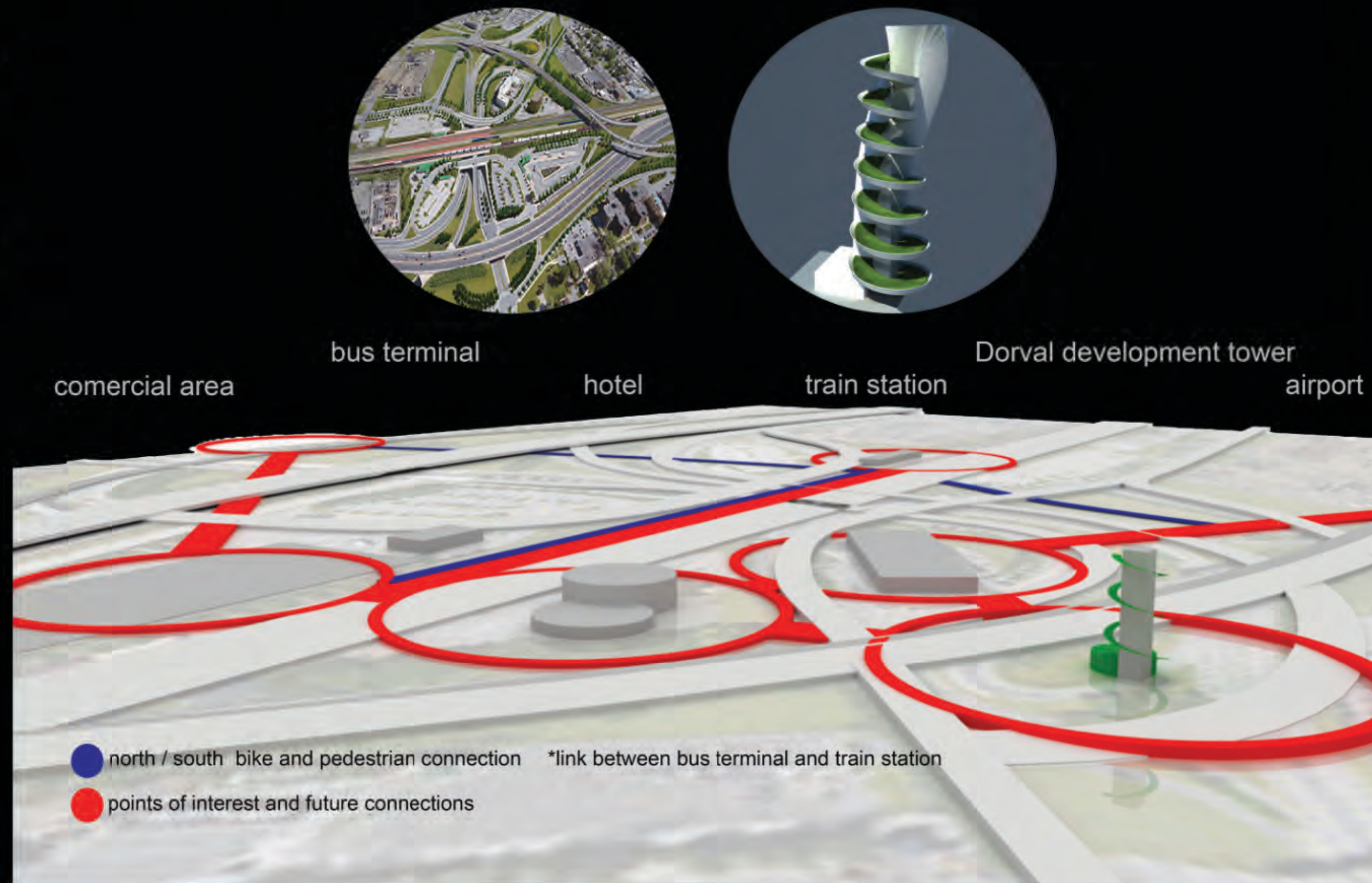

THE TURCOT

The intervention will bridge all the main infrastructures cutting the area and will connect both physically and functionally the St. Jacques Escarpment to the areas on the other side of the Lachine canal. The landscape will be used for recreational purposes, urban agriculture, energy production, and water filtering. The intervention will make this centrality an attraction both for Montreal and the local neighbourhoods.

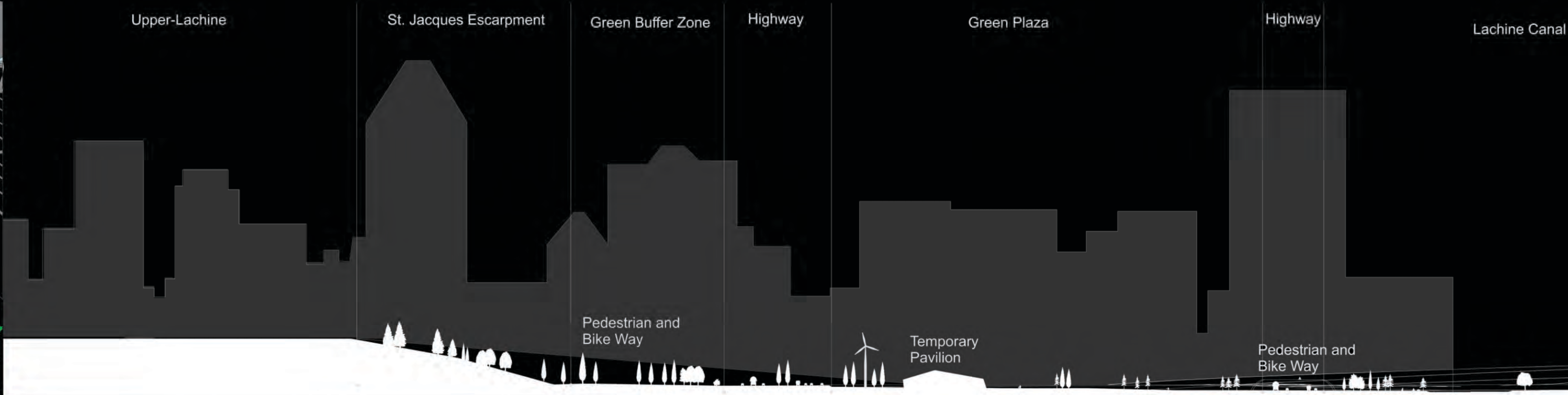
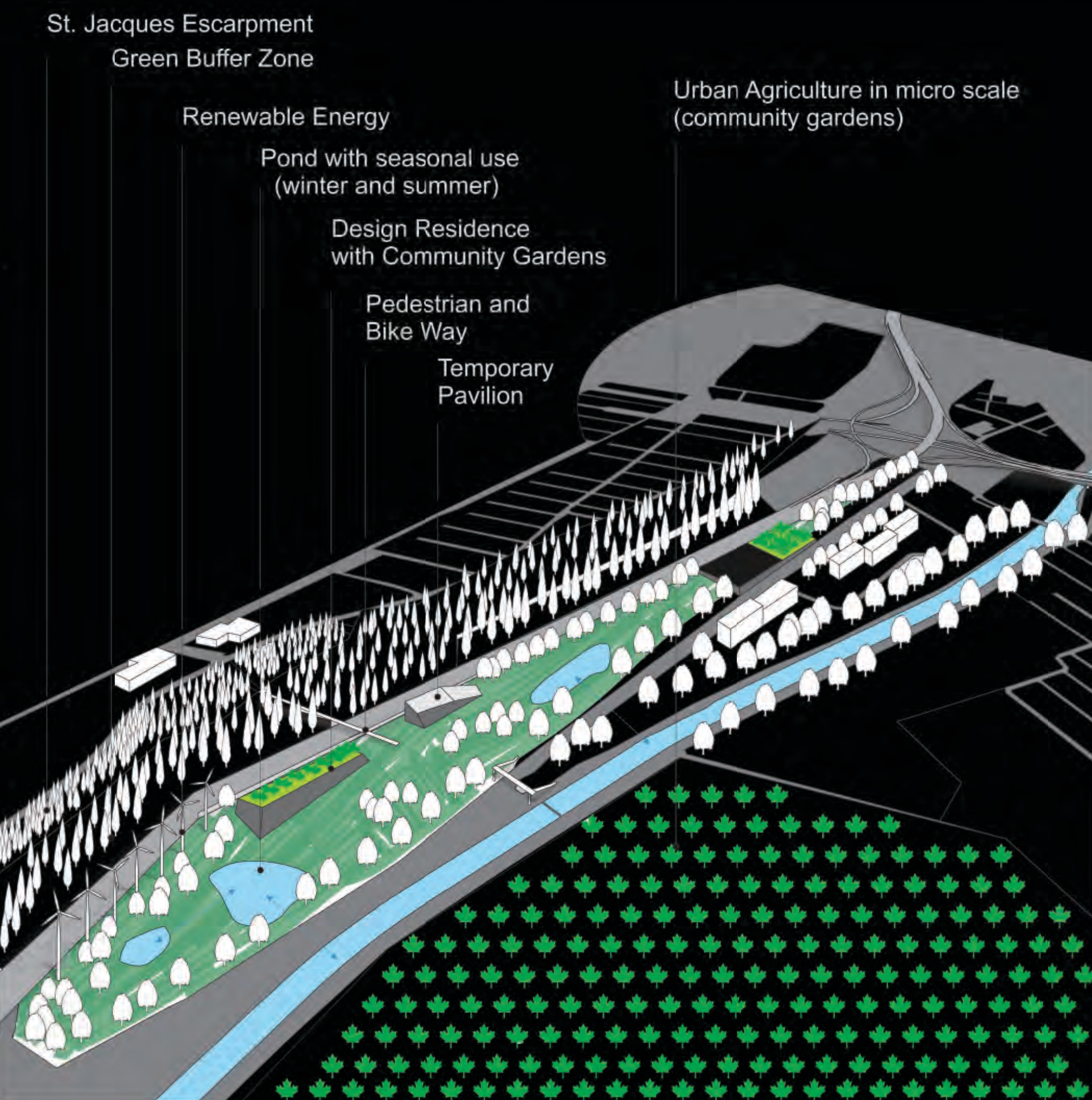

THE LACHINE CANAL

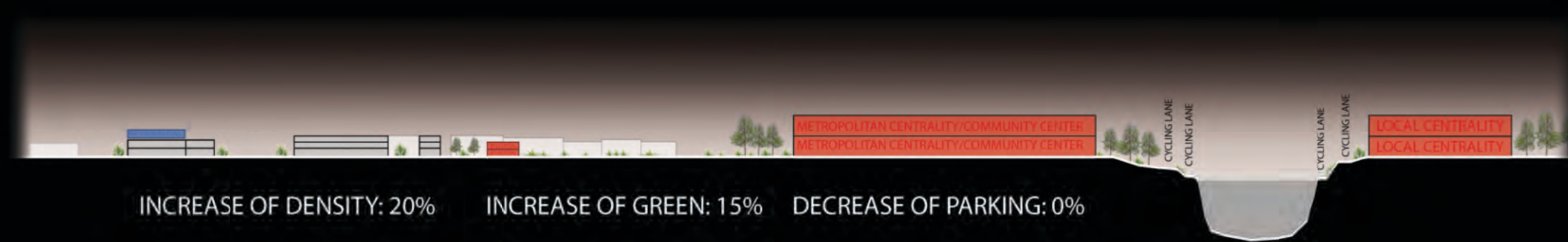

The area will have a Soft Urban Renewal: existing tissue in bad condition will be replaced and interesting traditional brick building will have an increase in density via the adding of a floor on the roof. There will be an increase of commercial areas and offices for creative industries. The area around the canal will be requalified and become a public park.

