

River concept project

Creating connections, green spaces and points of interest

SPRING AREA

DESCRIPTION:
First part of river concept - Spring. Water feature offering welcome and farewell special attention to the users of Trudeau Airport.

- Creating water/ice feature with illuminated water sprays for warm season and ice producing small jets for the winter.
- From the bigger lake water goes by the walkway that connects Dorval Station with Trudeau Airport, creating artificial river going to the airport.

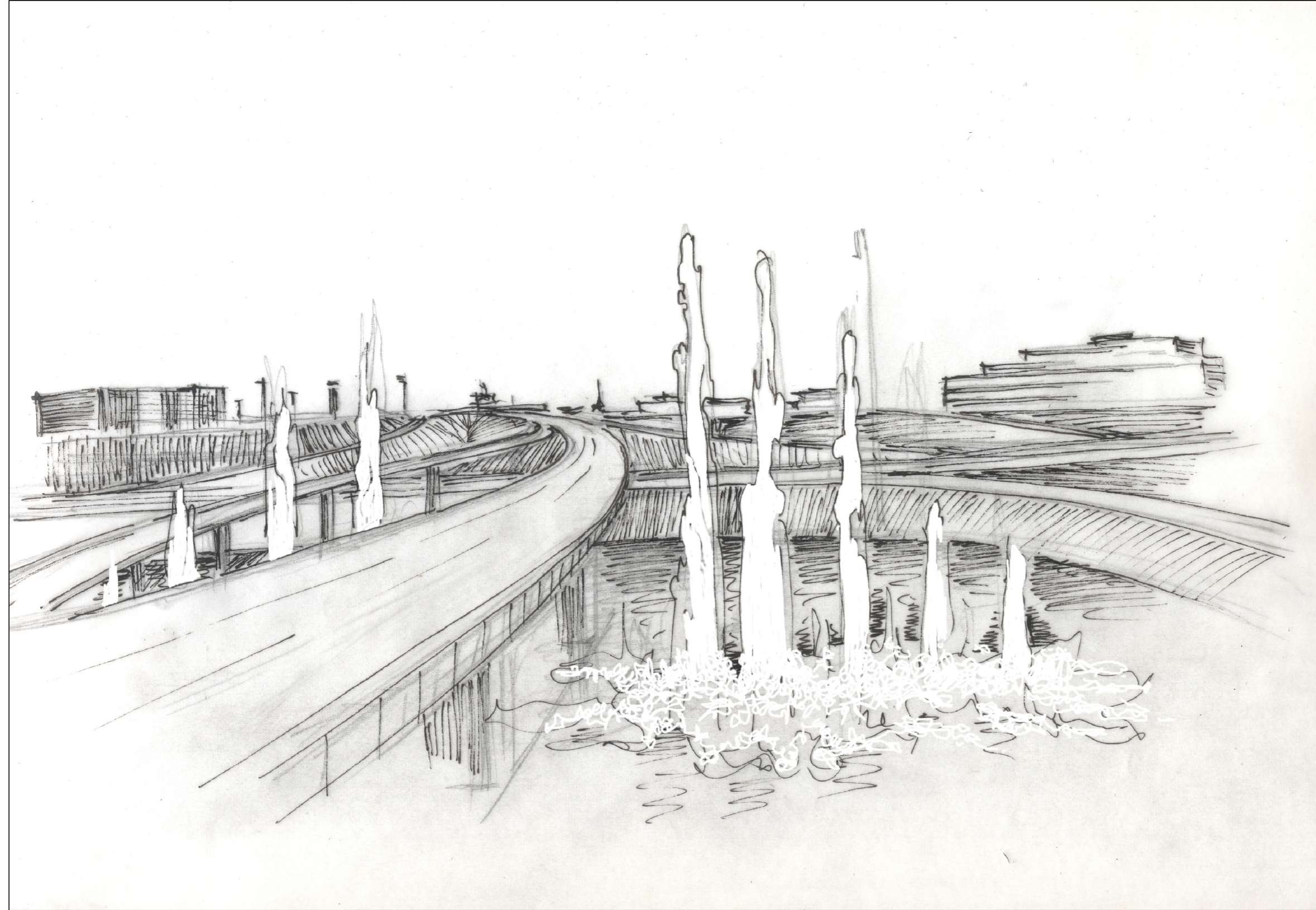

SAINT-PIERRE INTERCHANGE

DESCRIPTION:
Saint-Pierre interchange

- Creating park area west of the railway. This area connects Meadowbrook golf area with Lachine Canal by the Saint-Pierre interchange.
- Creating sound barriers at the north of interchange.
- Creating park and lake area east of interchange creating interesting vistas to the park and near Lachine Canal.

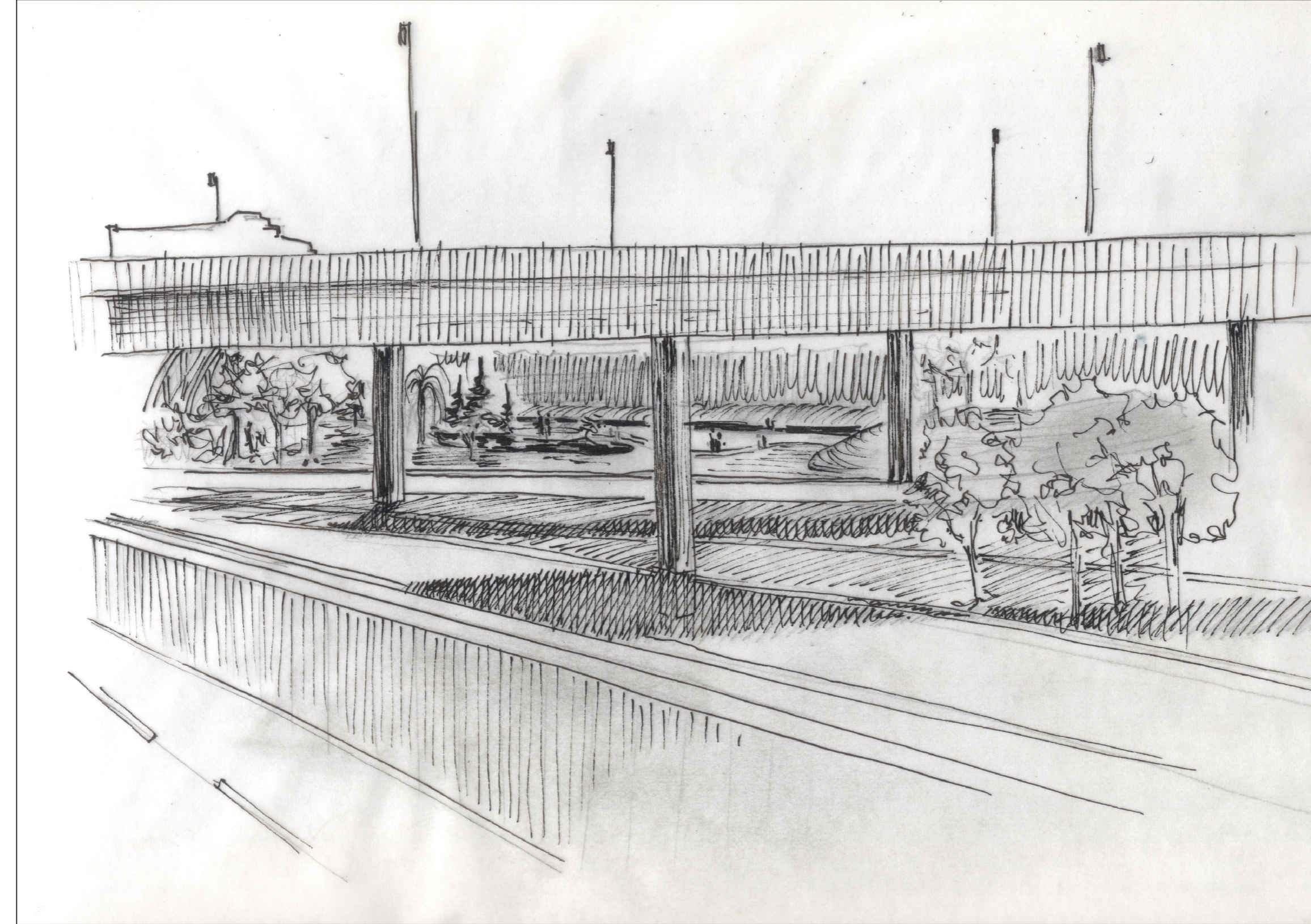

END OF THE ROAD AT VILLE-MARIE BOROUGH

DESCRIPTION:
Steel structure visually connected with the highway

- Wave-like steel structure visually starting at the entrance point of Ville-Marie tunnel and waving around
- Vertical steel strings from upper part of the structure to the ground gives the opportunity for filling painting-like or different kind of temporary installations.

Visually there is no end of the road leading to the sky.

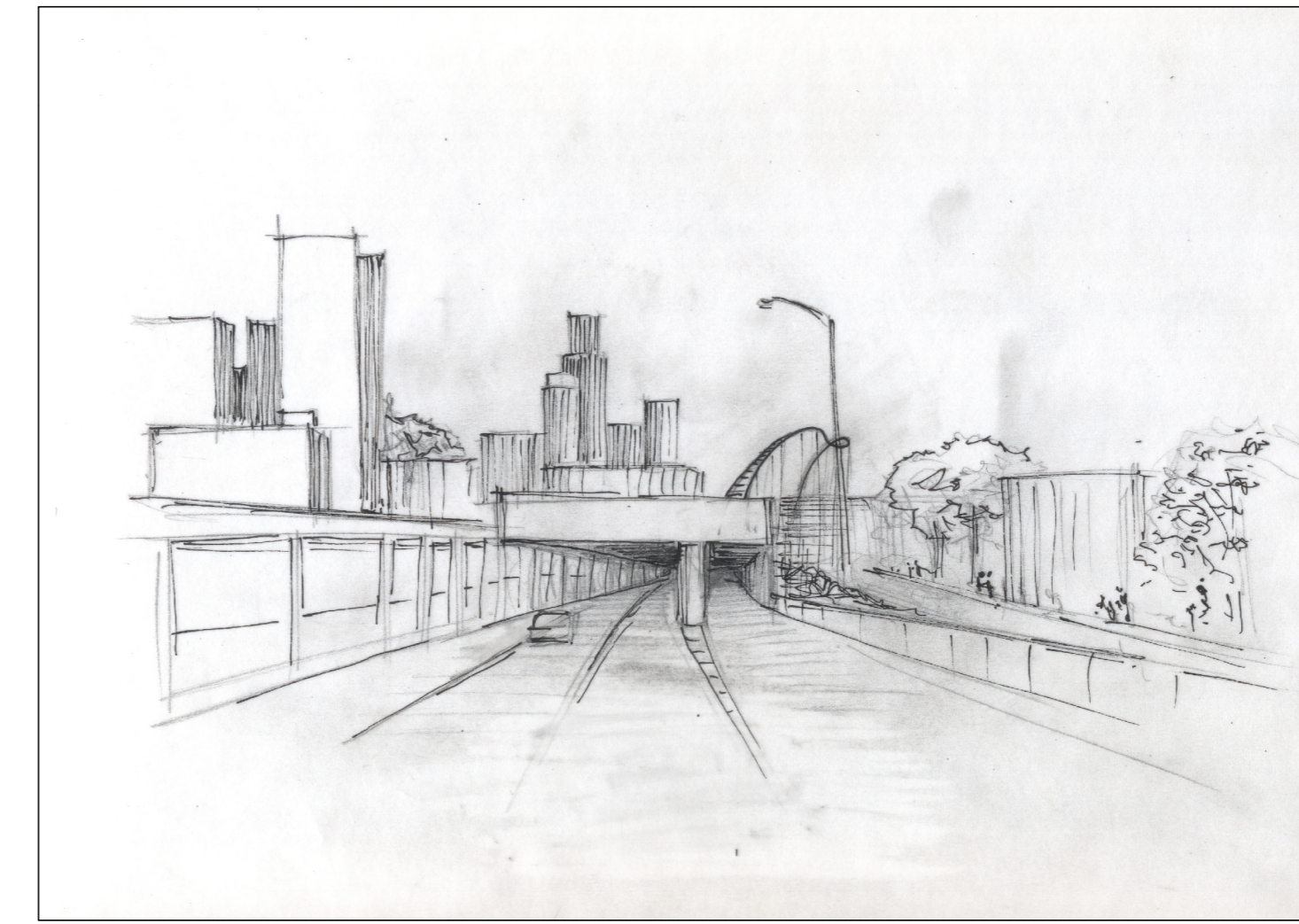

ROOF GARDENS

DESCRIPTION:
Possibility of creating green spaces on the roof tops

- Green area producing oxygen as well as visual effect.
- Easy maintenance of inner temperatures
- Depth from 2-30cm irrigated or non-irrigated soil is enough to create greener space

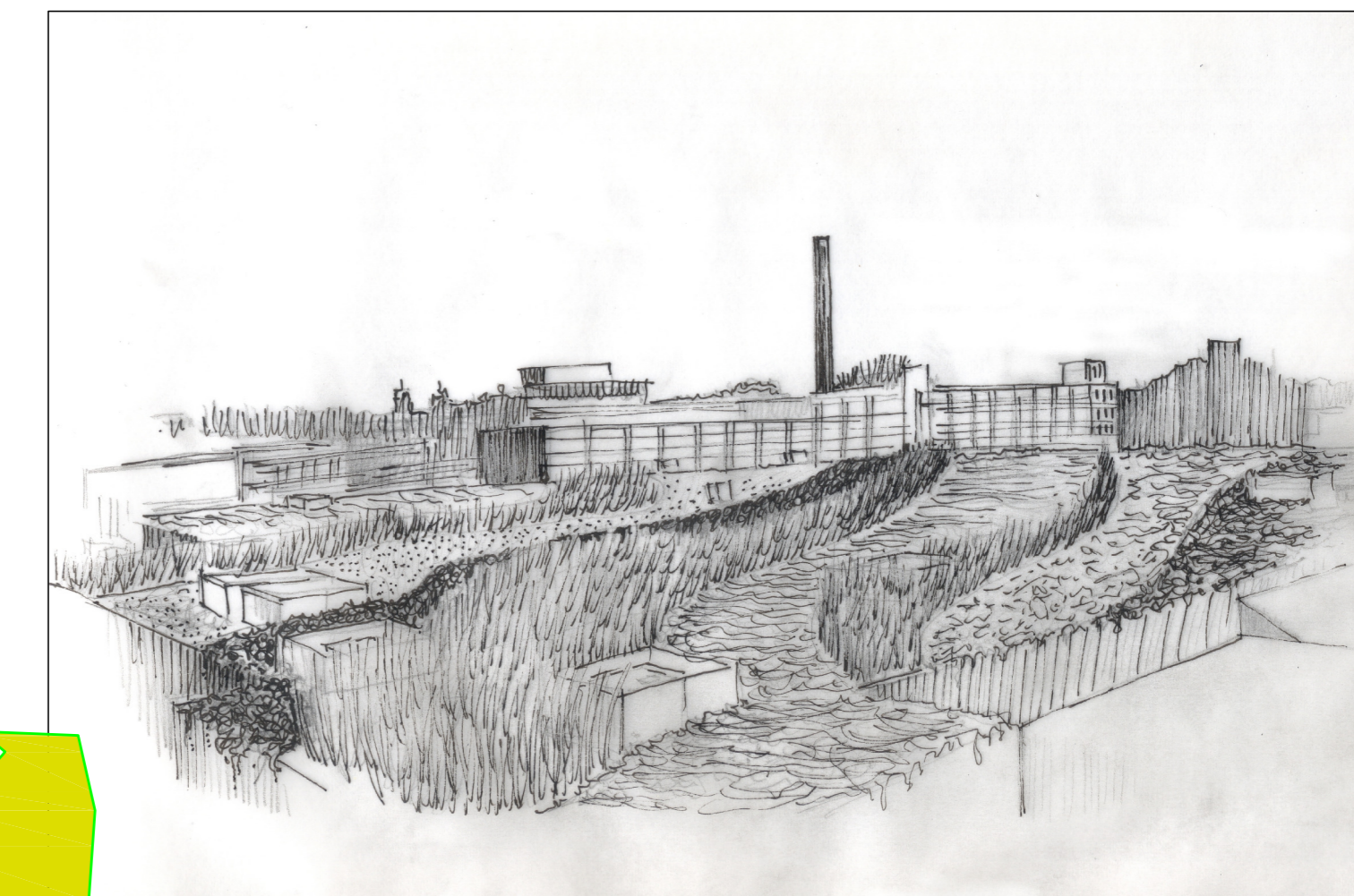

SAINT-HENRI NEIGHBOURHOOD GREEN AREAS

DESCRIPTION:
Green areas across the railway

- Creating elevated areas by the railway that forms tunnel-like structure. This structure significantly reduce noise and give possibility of walkways crossing

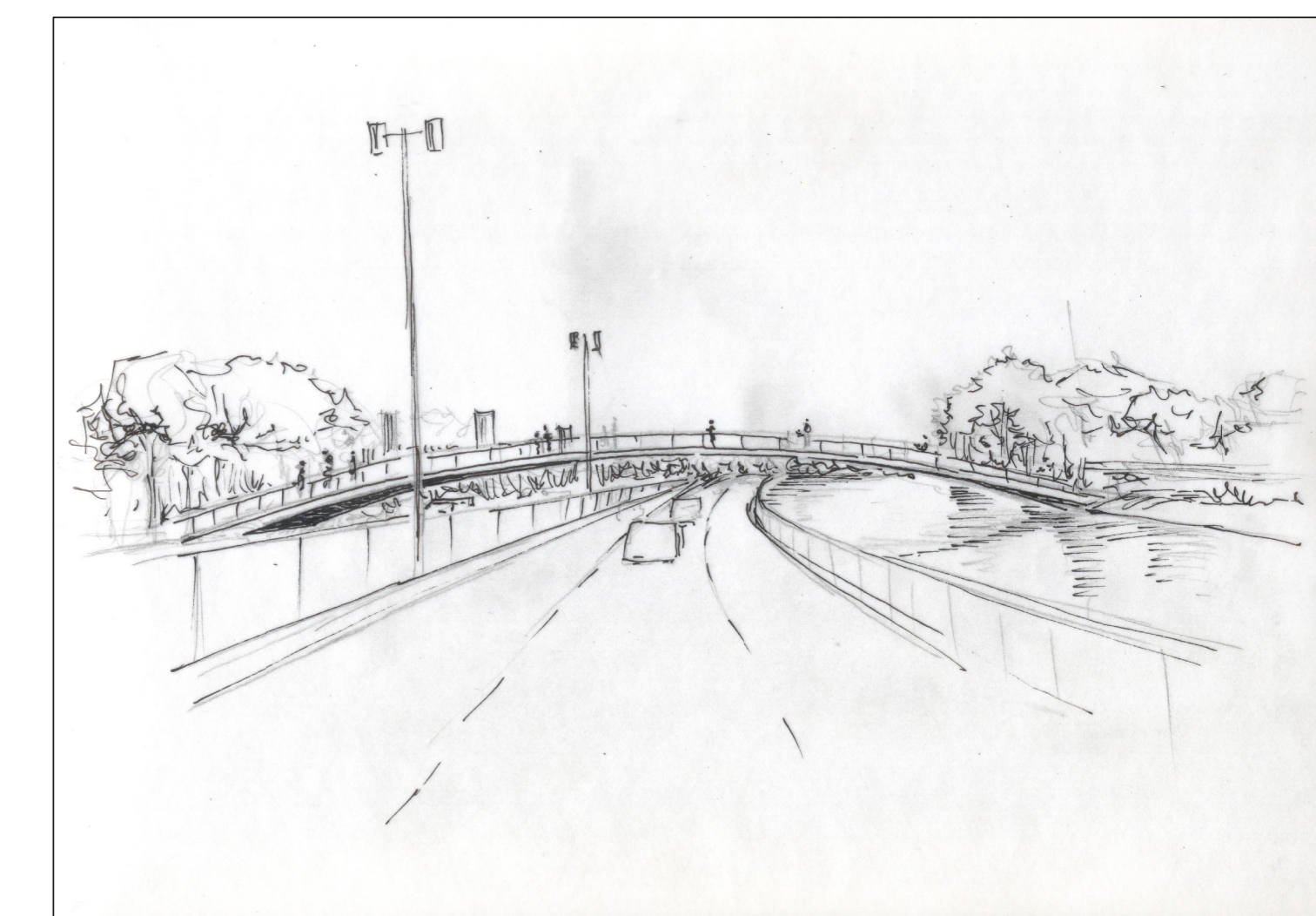
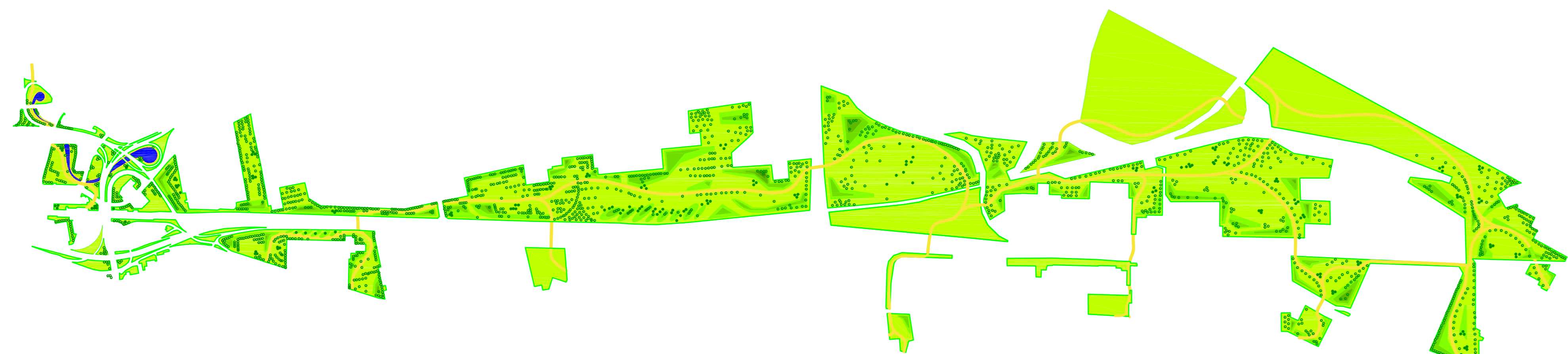
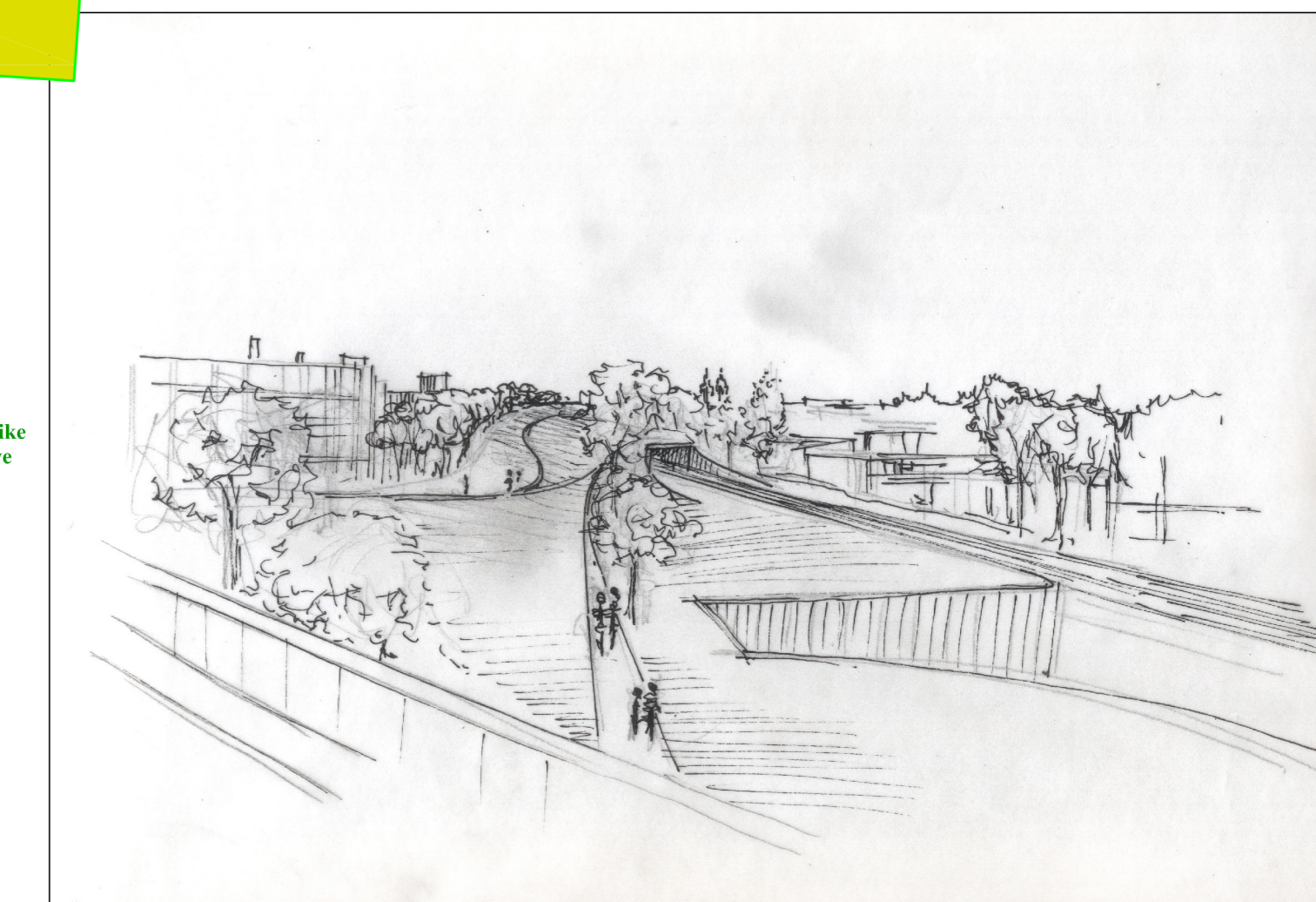

CABOT AREA PARK

DESCRIPTION:
Industrial area park connecting Saint-Henri Neighbourhood and Aqueduct Canal

OBJECTIVES:

- Connecting Saint-Henri Neighbourhood and Aqueduct Canal
- Easy passage to Aqueduct Canal

SOLUTIONS:

- Park area and light bridge to Aqueduct Canal
- Walkways to Lachine area

BOAT PARK CROSS SECTION

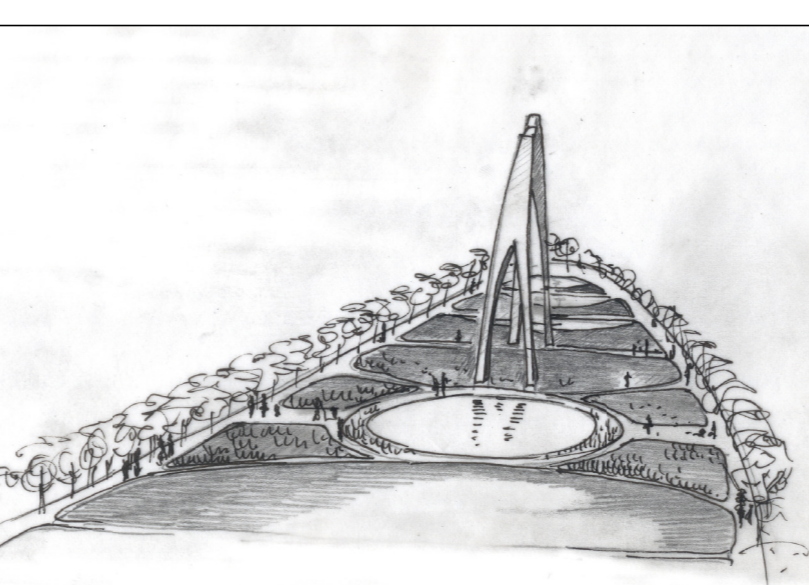
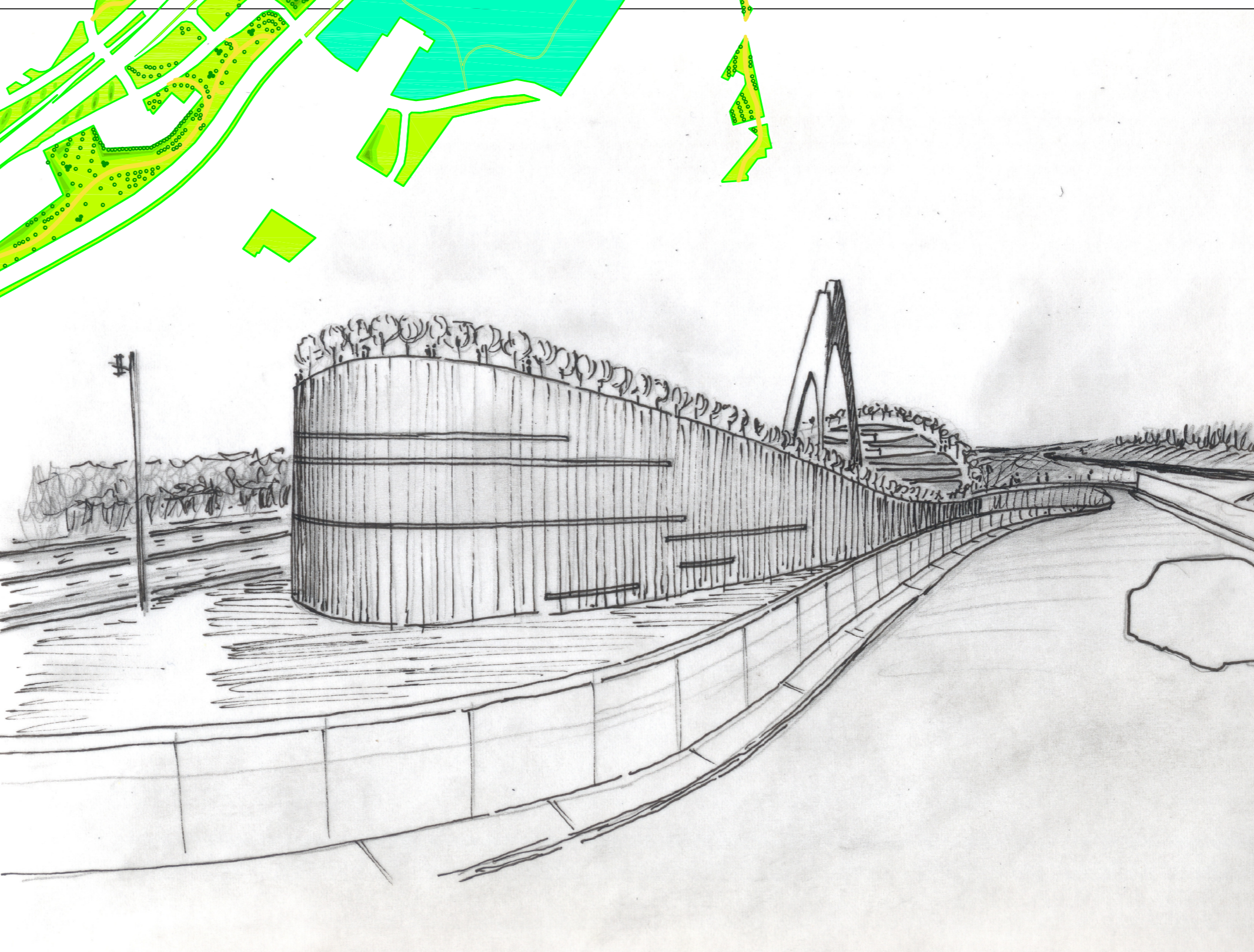
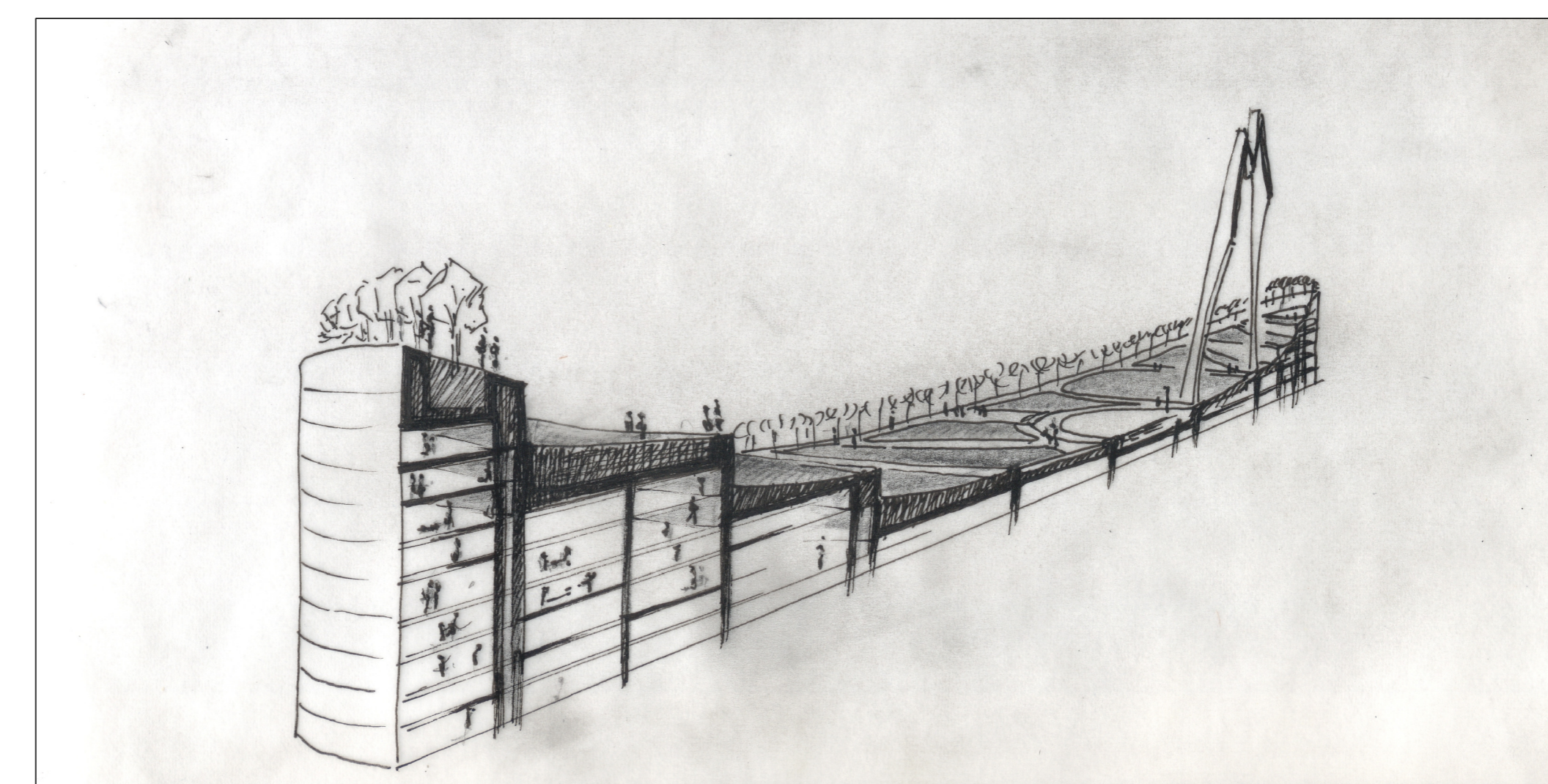

BOAT PARK

DESCRIPTION:
As a part of river concept giant boat that leads towards the center

- Creating Boat park with shape preserving from the noise of surrounding areas
- Creating of opportunity for up to 30 storey building areas at both ends of the park
- Creating emblematic views from and to different areas like Saint-Jacques Escarpment, Lachine Canal, Mount Royal etc.
- Creating focal point Entertainment with great possibilities for children and grownups
- Creating connection between Saint-Jacques Escarpment and Lachine Canal
- Creating spectacular views from any kind of transport - boat, car, train, bicycle, plane etc.
- Creating emblematic night vistas by illuminating M-shaped structure with rays of light representing ropes of a boat
- Potential of closing with glass part of upper areas and creating glass "Noah's ark" structure with exotic plants and animals

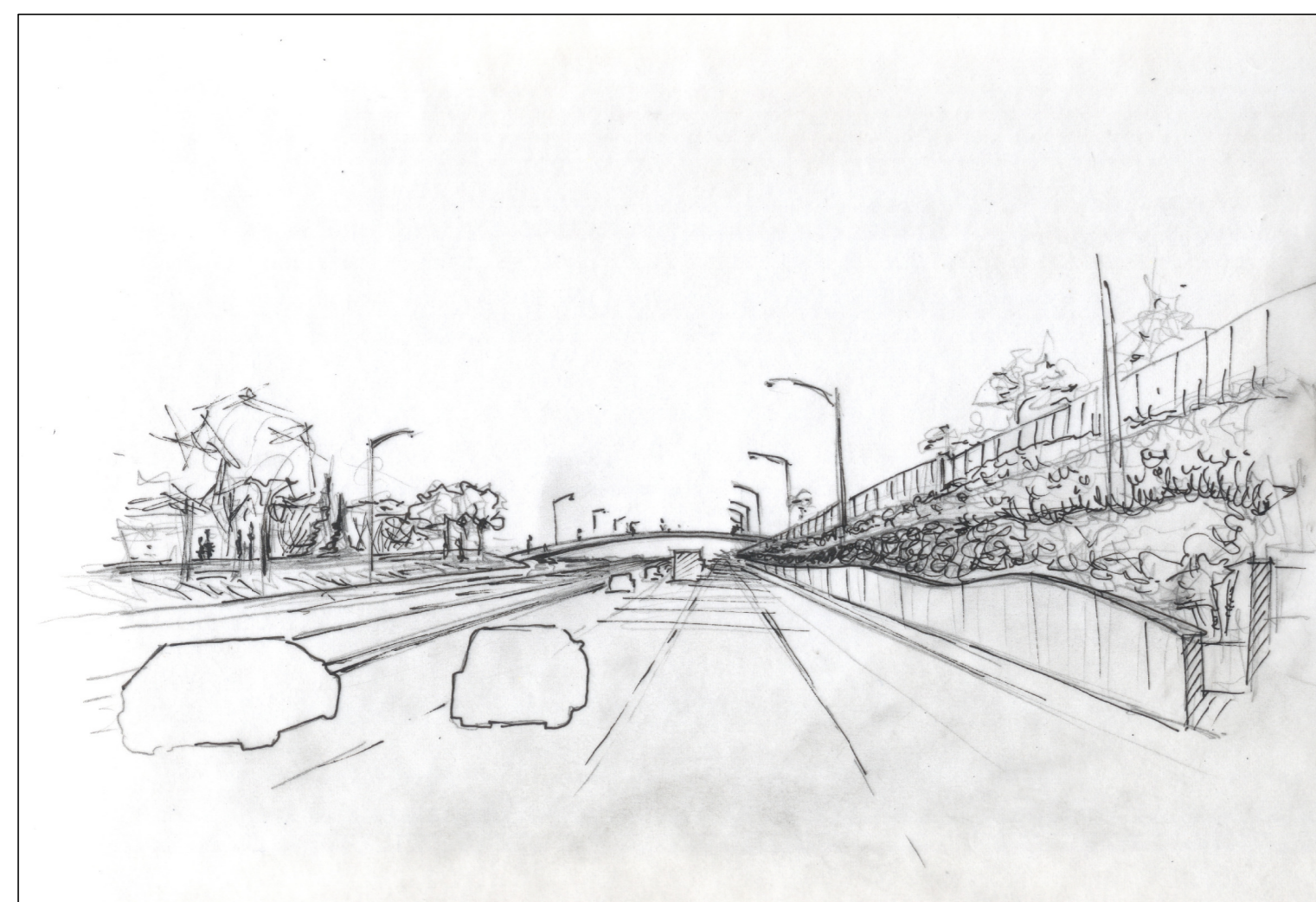

CYCLING/WALKING BRIDGE CROSSING THE HIGHWAY

DESCRIPTION:
Light bridge crossing the A 20 highway

- Light bridge crossing highway and railway, connecting Industrial area and City of Dorval.
- Wave shaped hedges in front of sound barrier wall for reducing grayish appearance



CYCLING/WALKING BRIDGE CROSSING THE HIGHWAY

DESCRIPTION:
Light bridge crossing the A 20 highway

- Light bridge crossing highway and railway, connecting Industrial area and City of Dorval.

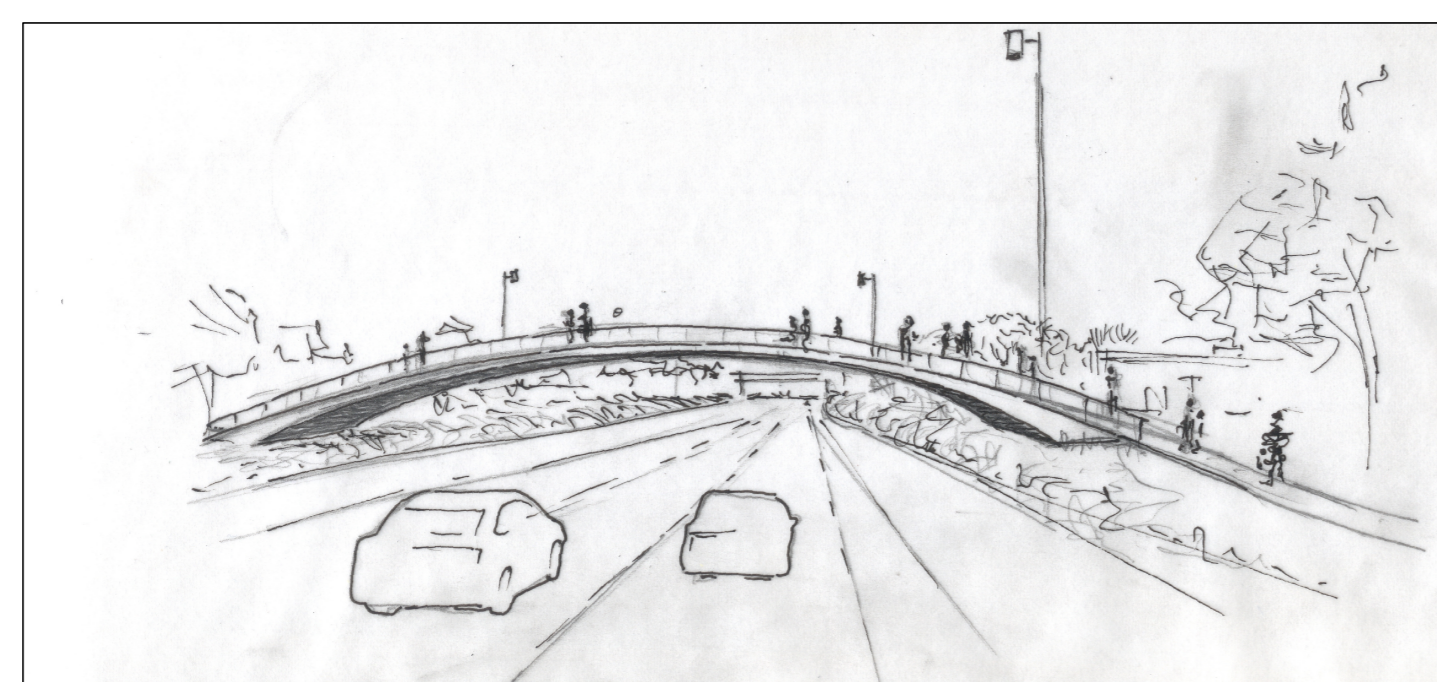

CYCLING/WALKING BRIDGE CROSSING THE HIGHWAY

DESCRIPTION:
Light bridge crossing the A 20 highway

OBJECTIVES:

- Creating South-North connection between Industrial north and living South part of Lachine Borough
- Creating connection between Lachine Station and living part of Lachine Borough without using 55 avenue crossing

SOLUTIONS:

- Light bridge crossing highway and railway, connecting Industrial area and City of Dorval.