

# A travers les ares : Les Boîtes «à vivre»

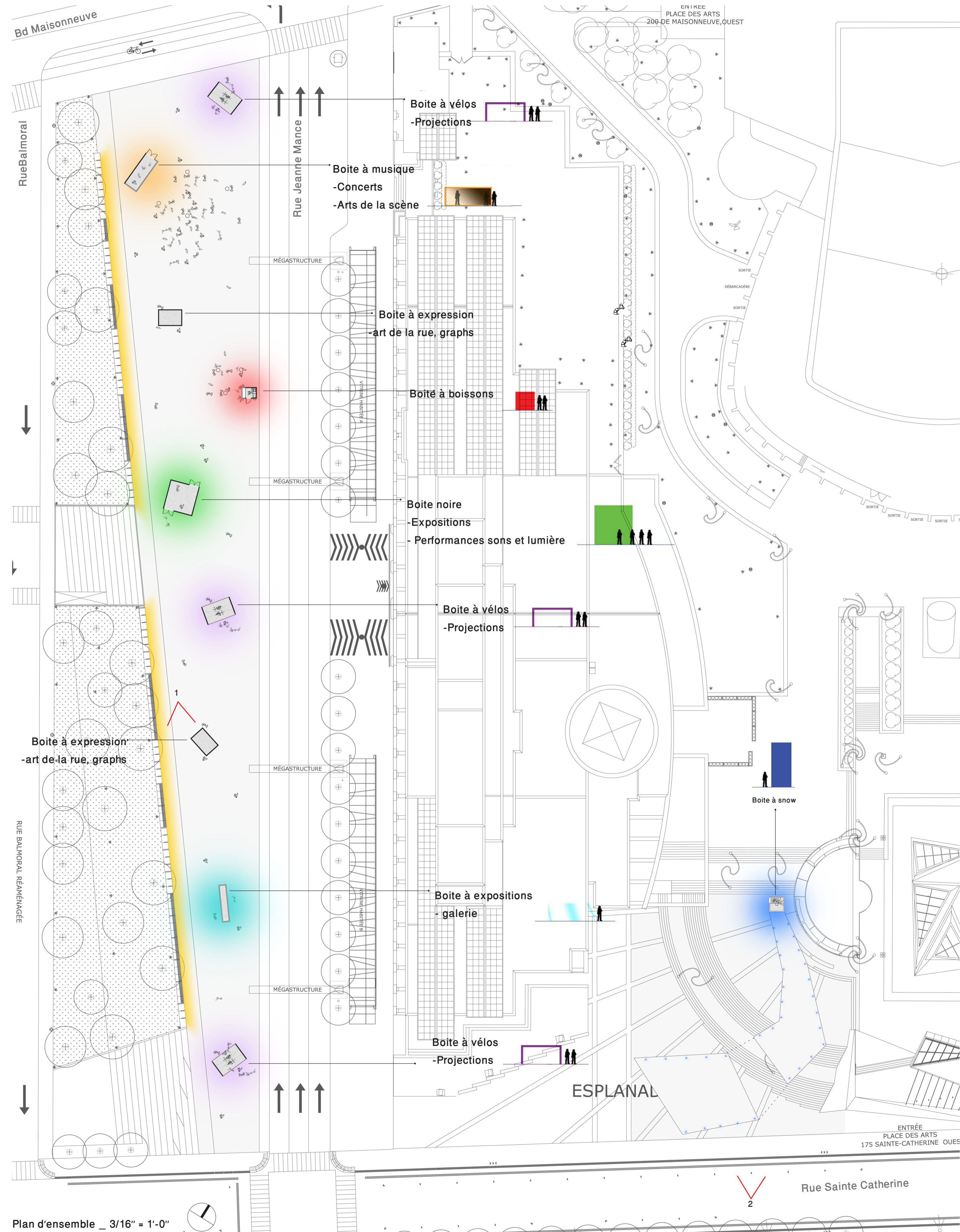

ATTIRER

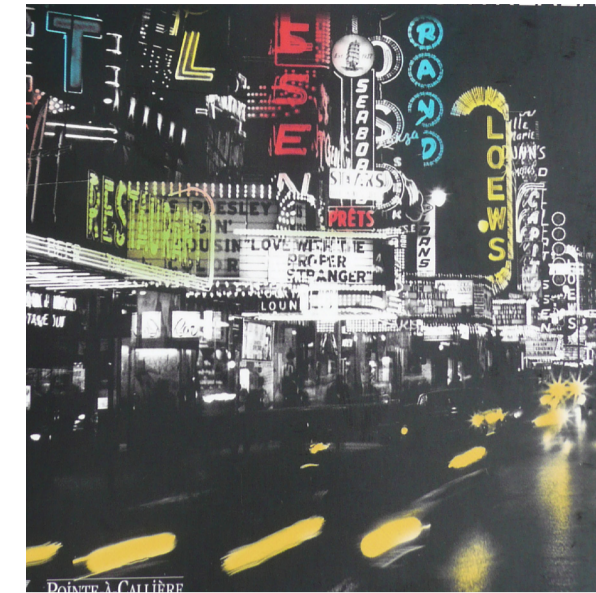

La couleur comme enseigne

PONCTUER

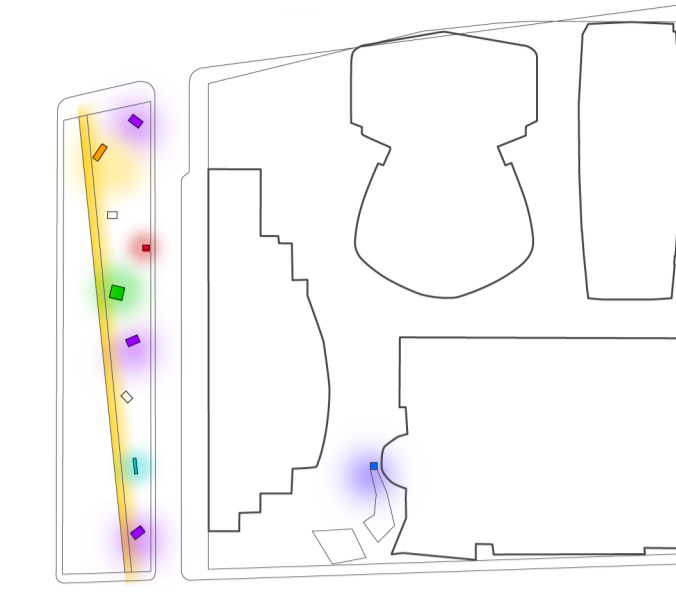

Luminothérapie-Code de couleur

INTÉRAGIR

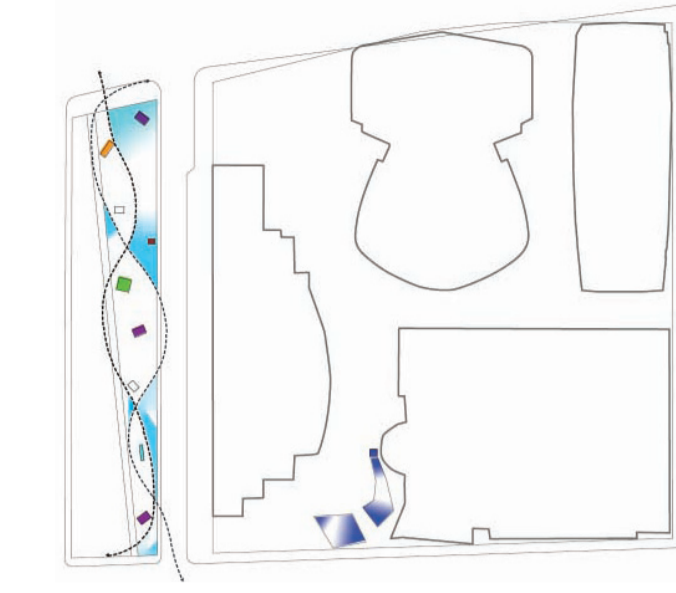

Dispersion des éléments et occupation de l'espace

DÉCOUVRIR

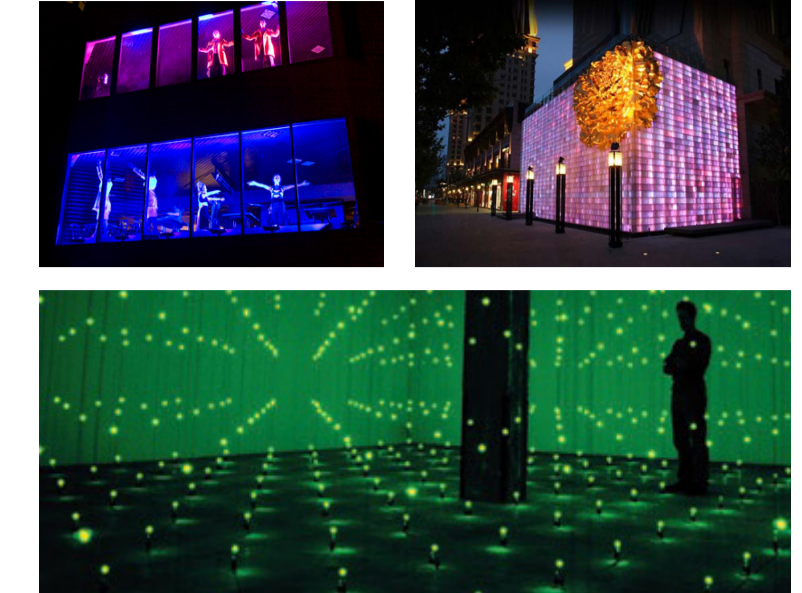

Ambiances lumineuses



1-La place des festivals\_Parcourir les arts



2-Vue de Sainte Catherine\_Le snow park